



Plastic Wicker Basket Installation Instructions

(EBC PN: #368815, #368816, #368817 and #368818)



EBC_#368815_INSTR_MAR11

Plastic Wicker Basket Installation Instructions

Designed to fit most 700c & 26" bicycle forks with eyelets. Not intended for mounting to the hub axle. Will not work on bicycles equipped with a suspension fork.

DIFFICULTY LEVEL: Easy

If you are not comfortable installing basket, please have it professionally installed by your Electra dealer.

1) Tools Needed

- Phillips screwdriver
- 8mm open end or box wrench
(or small adjustable wrench)
- 32mm open-end wrench – for bikes with
1" headsets (or large adjustable wrench)
- 36mm open-end wrench - for bikes with
1 1/8" headsets (or large adjustable wrench)
- 4mm hex head wrench
- 6mm hex head wrench



2) Parts List

- (1) plastic wicker basket
- (1) steel fork strut
- (1) steel plate buckle w/ ridge (3cm x 4.5cm)
- (2) nylon lock nuts
- (4) 16mm long Phillips head machine screws
- (2) hex head machine screws w/washers,
12mm long
- (6) steel washers
- (1) steel inner plate (7cm wide x 1.5cm tall)
- (1) headset bracket for
1" headset-equipped bikes
- (1) headset bracket for
1 1/8" headset-equipped bikes



STEP 1: Installation of fork strut to basket

- 1) Mount strut legs to bottom of basket with two 16mm Phillips head screws and the steel plate buckle.
- 2) Place bracket in forward position for most cruiser models, in rearward position for most Townie and Amsterdam models.
- 3) Tighten screws using Phillips head screwdriver.
DO NOT OVERTIGHTEN.

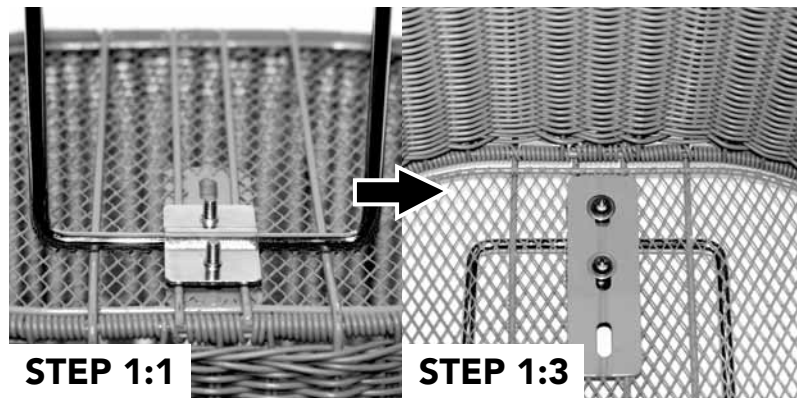

STEP 2: Installation of headset bracket

- 1) Remove stem/handlebar combination using a 6mm hex wrench
- 2) Remove top nut using 32, 36mm or adjustable wrench and put aside
- 3) Remove steel key washer
- 4) Install mounting bracket in place of key washer, lip side faces up
- 5) Reinstall top nut using 32, 36mm or adjustable wrench
- 6) Reinstall stem/handlebar combination using a 6mm hex wrench



Note: Most Electra Cruiser models use 1" headsets while steel-framed Amsterdam models use 1" and aluminum-framed Amsterdam models and Townie models use 1 1/8" headsets. If mounting to a late-model Townie, it is necessary to remove the conical headset spacer. Put spacer aside for future use if basket is no longer installed. If you are unsure of the size of your headset, contact your local Electra dealer.

STEP 3: Attaching basket to headset bracket

- 1) Thread Phillips head screws through steel washers and inner plate
- 2) Thread Phillips head bolts into headset bracket and additional washers
- 3) Install nylon lock nuts, tighten

STEP 3:1-3

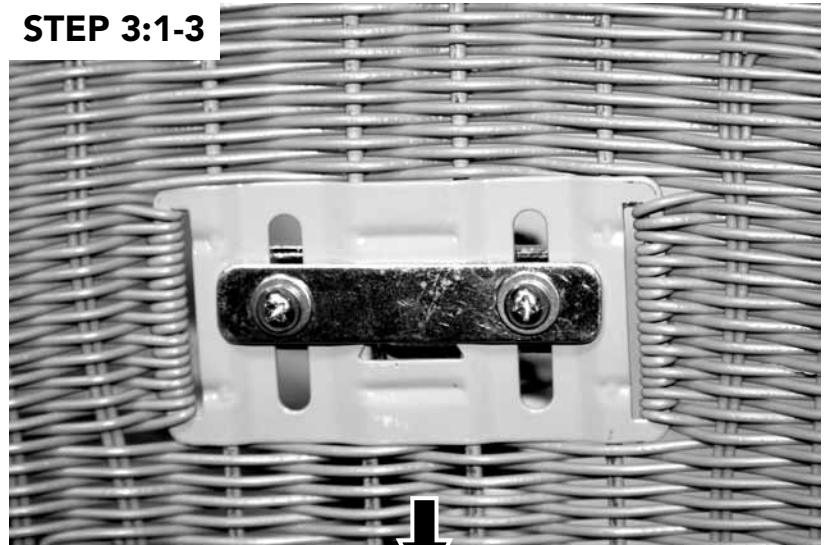

STEP 4: Attaching fork strut to fork eyelets

- 1) Remove any existing bolts that may be supporting fender stays (front/upper stay only)
- 2) Using the included hex head bolts with washers, mount the fork strut to the upper/front eyelets
- 3) Reinstall any existing fender stays



If you have questions regarding assembly, please visit your local Electra dealer or call Electra Customer Service at 800-261-1644 (8AM – 4PM Pacific Time).

Electra Bicycle Part Numbers:

- 368815 – Plastic Wicker Basket, black
- 368816 – Plastic Wicker Basket, brown
- 368817 – Plastic Wicker Basket, tan
- 368818 – Plastic Wicker Basket, white

STEP 4:1-3

