

# RECALL NOTICE

## ELECTRA BICYCLE COMPANY, LLC

### Amsterdam Model Bicycles: Potential Fall Hazard



Chainguard

Location of Frame Number  
(Underside of Bottom Bracket)

If pushed against the chain, the bicycles's chainguard can derail the chain, creating a potential fall hazard. The recall includes certain Amsterdam bicycles in the Classic 3, Original 3, Royal 8 and Sport 3 styles. The recall does not affect bicycles in those styles with frame numbers beginning with "EL" or with chainguard marked "06/08". The recall does not affect bicycles with 4 screws connecting the front and rear chainguard pieces. The recall does not include Amsterdam bikes in the Balloon 8 and Sport 9 styles or any other Electra bikes.

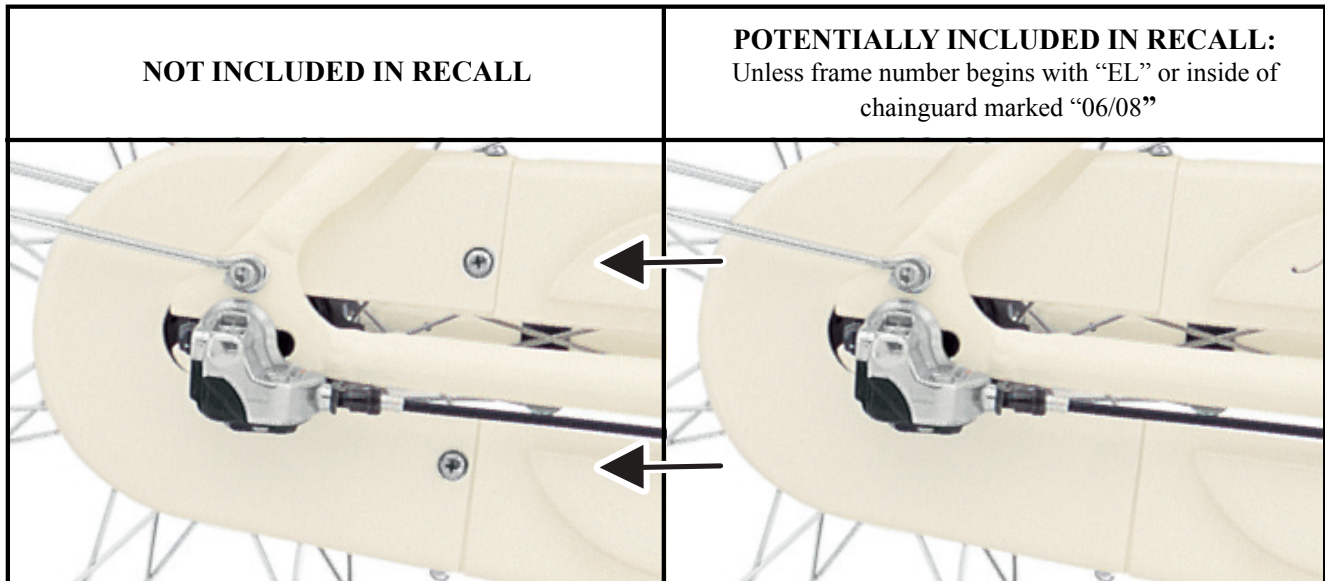

*Sold from January 2007 through June 2008 for between \$399 and \$850.*

Consumers should bring the bicycle to an Electra dealer. A replacement chainguard part will be professionally installed at no charge.

**(800) 261-1644**

9 a.m. to 5 p.m. PT Monday through Friday, or visit

[www.electrabike.com](http://www.electrabike.com)